

Notes:

1. All new signs and markings shall comply with the MUTCD and FDOT design standards.
2. All locations are field marked, shall be sunshined before installation and hand dig unless otherwise noted.
3. This plan design to be printed on 11x17 sheets only.
4. ERADICATE Existing 6" Yellow Skip Centerline/RPM's.
5. All Word messages shall be installed in accordance with the "Standards Highway Signs and Markings" Book.
6. INSTALL 6" Solid Double Yellow Centerline With Bidirectional Yellow RPM's at 40' spacing.

Scale 1"=40'
North

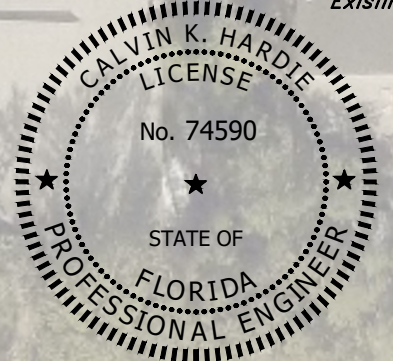
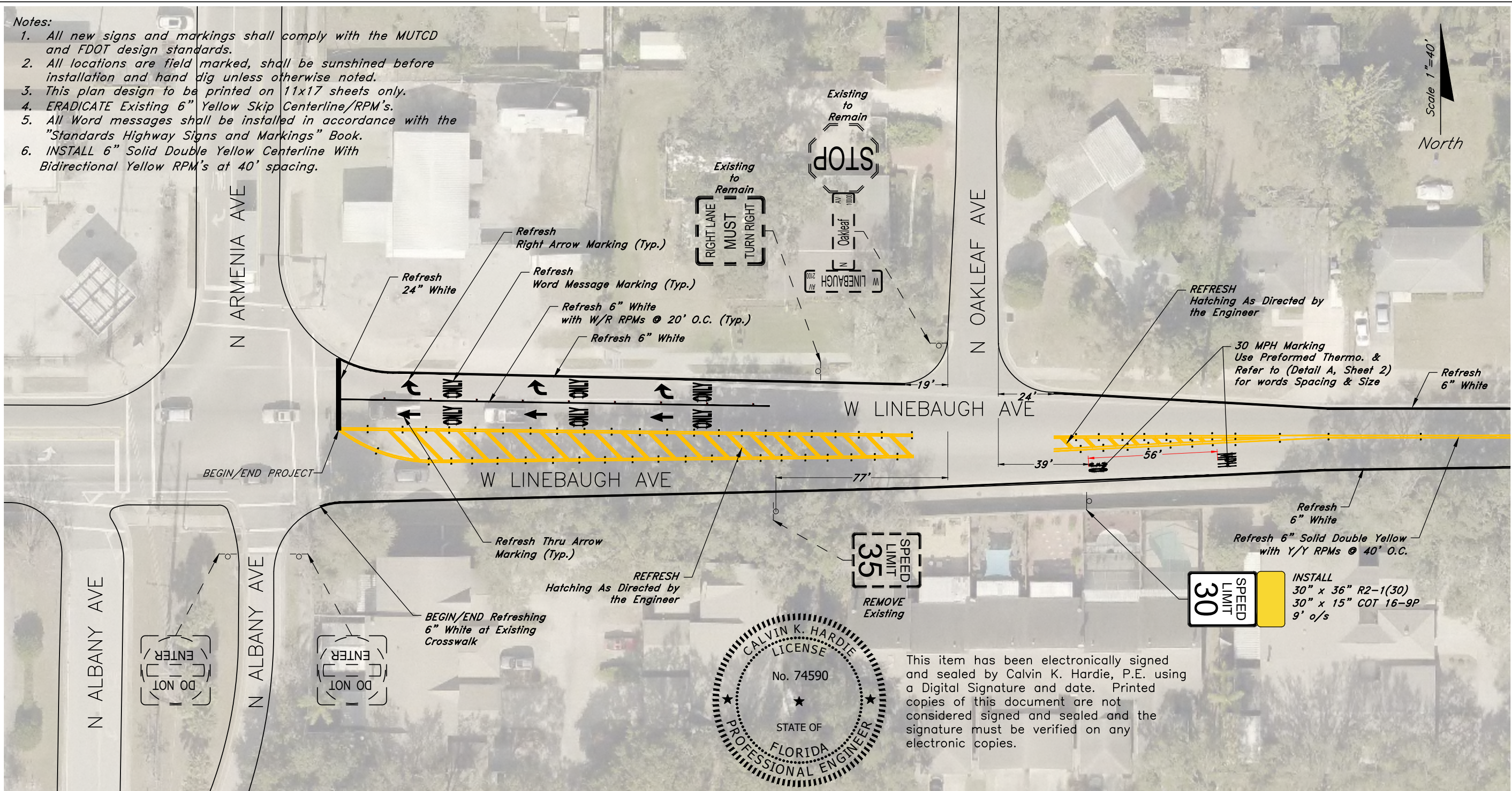

This item has been electronically signed and sealed by Calvin K. Hardie, P.E. using a Digital Signature and date. Printed copies of this document are not considered signed and sealed and the signature must be verified on any electronic copies.

WORK REQUEST NO. N0313	REQUESTED BY:	CALVIN HARDIE, P.E. P.E. LICENSE NUMBER 75490 CITY OF TAMPA CHIEF TRANSPORTATION ENGINEER 306 E JACKSON STREET TAMPA, FLORIDA 33602	CITY OF TAMPA TRANSPORTATION AND STORMWATER SERVICES DEPARTMENT			W LINEBAUGH AVE From N Armenia Ave To N Florida Ave	SHEET NO.
	PRIORITY: <input type="radio"/> AVG <input checked="" type="radio"/> HIGH <input type="radio"/> SPECIAL CASE		DESIGNED BY H. Nasralla	CHECKED BY B. Corey	DATE 11/18/2019		Signing & Pavement Markings Upgrades

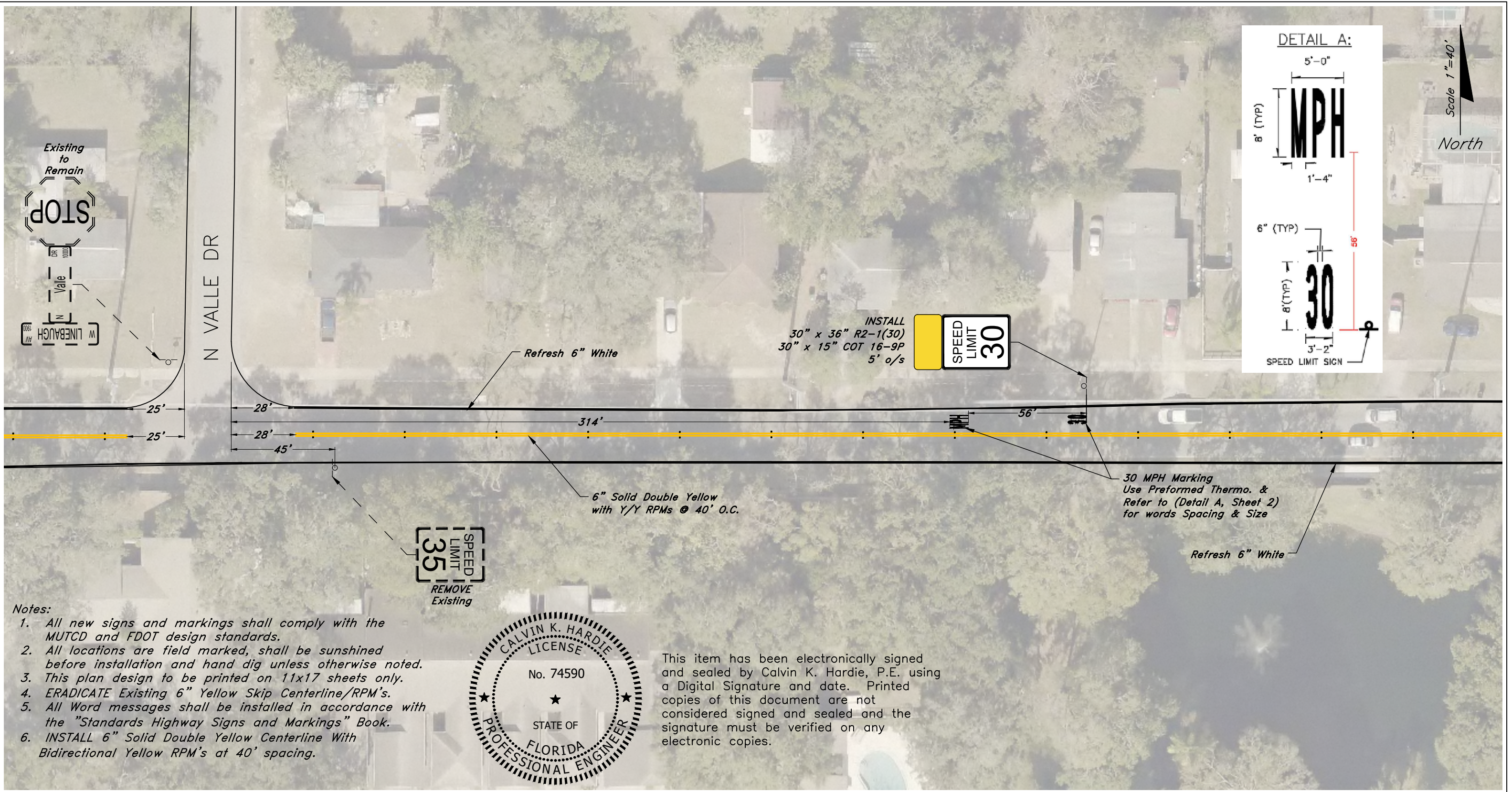

Existing to Remain
STOP
N VALLE
W LINEBAUGH AVE

N VALLE DR

Refresh 6" White

INSTALL
30" x 36" R2-1(30)
30" x 15" COT 16-9P
5' o/s

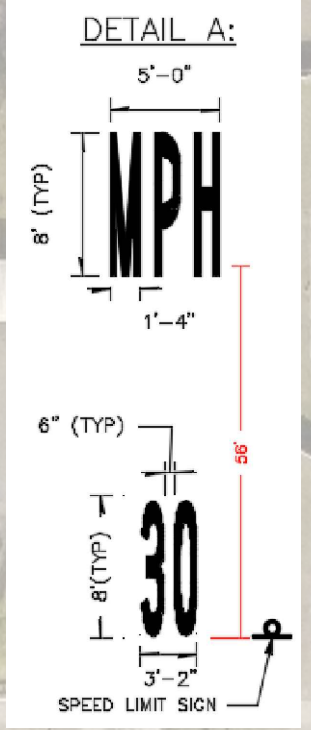

Scale 1"=40'
North



6" Solid Double Yellow
with Y/Y RPMs @ 40' O.C.

30 MPH Marking
Use Preformed Thermo. &
Refer to (Detail A, Sheet 2)
for words Spacing & Size

Refresh 6" White

Notes:

1. All new signs and markings shall comply with the MUTCD and FDOT design standards.
2. All locations are field marked, shall be sunshined before installation and hand dig unless otherwise noted.
3. This plan design to be printed on 11x17 sheets only.
4. ERADICATE Existing 6" Yellow Skip Centerline/RPM's.
5. All Word messages shall be installed in accordance with the "Standards Highway Signs and Markings" Book.
6. INSTALL 6" Solid Double Yellow Centerline With Bidirectional Yellow RPM's at 40' spacing.

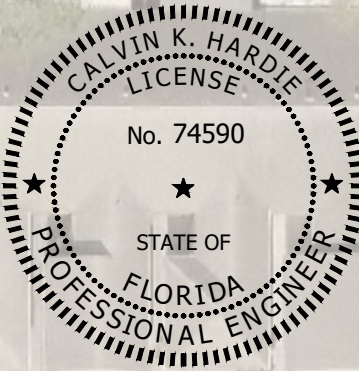

This item has been electronically signed and sealed by Calvin K. Hardie, P.E. using a Digital Signature and date. Printed copies of this document are not considered signed and sealed and the signature must be verified on any electronic copies.

WORK REQUEST NO. N0313	REQUESTED BY:	CALVIN HARDIE, P.E. P.E. LICENSE NUMBER 75490 CITY OF TAMPA CHIEF TRANSPORTATION ENGINEER 306 E JACKSON STREET TAMPA, FLORIDA 33602	CITY OF TAMPA TRANSPORTATION AND STORMWATER SERVICES DEPARTMENT			W LINEBAUGH AVE From N Armenia Ave To N Florida Ave	SHEET NO. 2 Of 11
	PRIORITY: <input type="radio"/> AVG <input checked="" type="radio"/> HIGH <input type="radio"/> SPECIAL CASE		DESIGNED BY H. Nasralla	CHECKED BY B. Corey	DATE 11/18/2019		

Notes:

1. All new signs and markings shall comply with the MUTCD and FDOT design standards.
2. All locations are field marked, shall be sunshined before installation and hand dig unless otherwise noted.
3. This plan design to be printed on 11x17 sheets only.
4. ERADICATE Existing 6" Yellow Skip Centerline/RPM's.
5. All Word messages shall be installed in accordance with the "Standards Highway Signs and Markings" Book.
6. INSTALL 6" Solid Double Yellow Centerline With Bidirectional Yellow RPM's at 40' spacing.

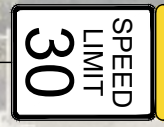
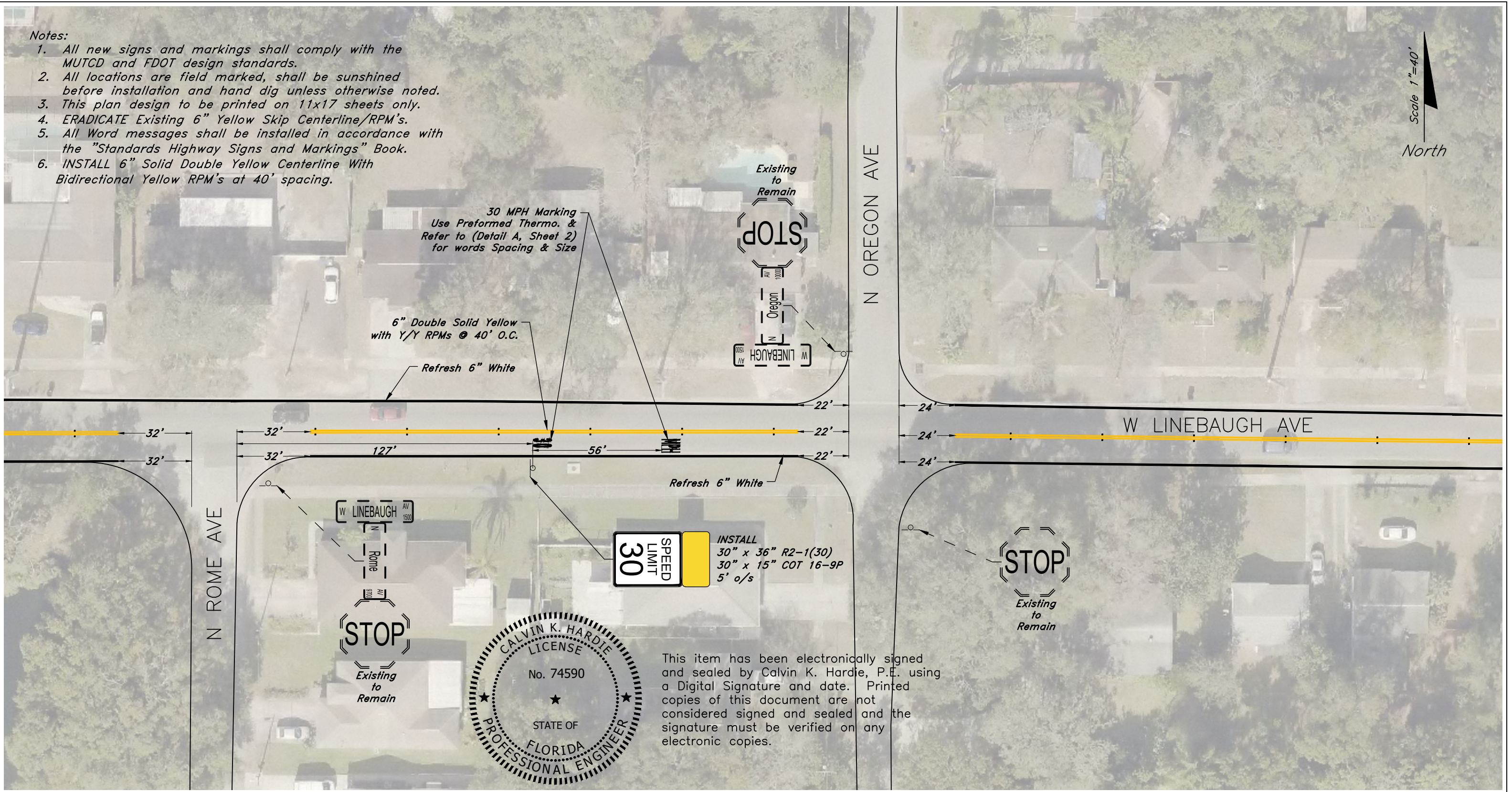
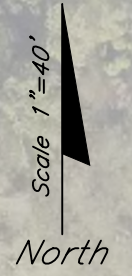

INSTALL
30" x 36" R2-1(30)
30" x 15" COT 16-9P
5' o/s

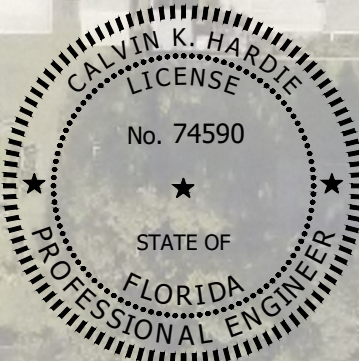

This item has been electronically signed and sealed by Calvin K. Hardie, P.E. using a Digital Signature and date. Printed copies of this document are not considered signed and sealed and the signature must be verified on any electronic copies.

WORK REQUEST NO. NO313	REQUESTED BY:	CALVIN HARDIE, P.E. P.E. LICENSE NUMBER 75490 CITY OF TAMPA CHIEF TRANSPORTATION ENGINEER 306 E JACKSON STREET TAMPA, FLORIDA 33602	CITY OF TAMPA TRANSPORTATION AND STORMWATER SERVICES DEPARTMENT			W LINEBAUGH AVE From N Armenia Ave To N Florida Ave	SHEET NO. 3 of 11
	PRIORITY: ○ AVG ● HIGH ○ SPECIAL CASE		DESIGNED BY H. Nasralla	CHECKED BY B. Corey	DATE 11/18/2019		

Notes:

1. All new signs and markings shall comply with the MUTCD and FDOT design standards.
2. All locations are field marked, shall be sunshined before installation and hand dig unless otherwise noted.
3. This plan design to be printed on 11x17 sheets only.
4. ERADICATE Existing 6" Yellow Skip Centerline/RPM's.
5. All Word messages shall be installed in accordance with the "Standards Highway Signs and Markings" Book.
6. INSTALL 6" Solid Double Yellow Centerline With Bidirectional Yellow RPM's at 40' spacing.

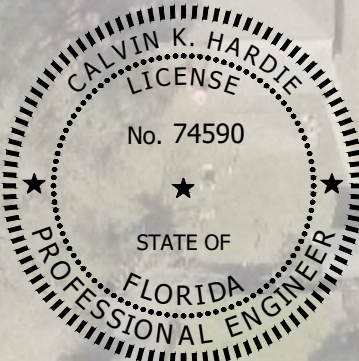
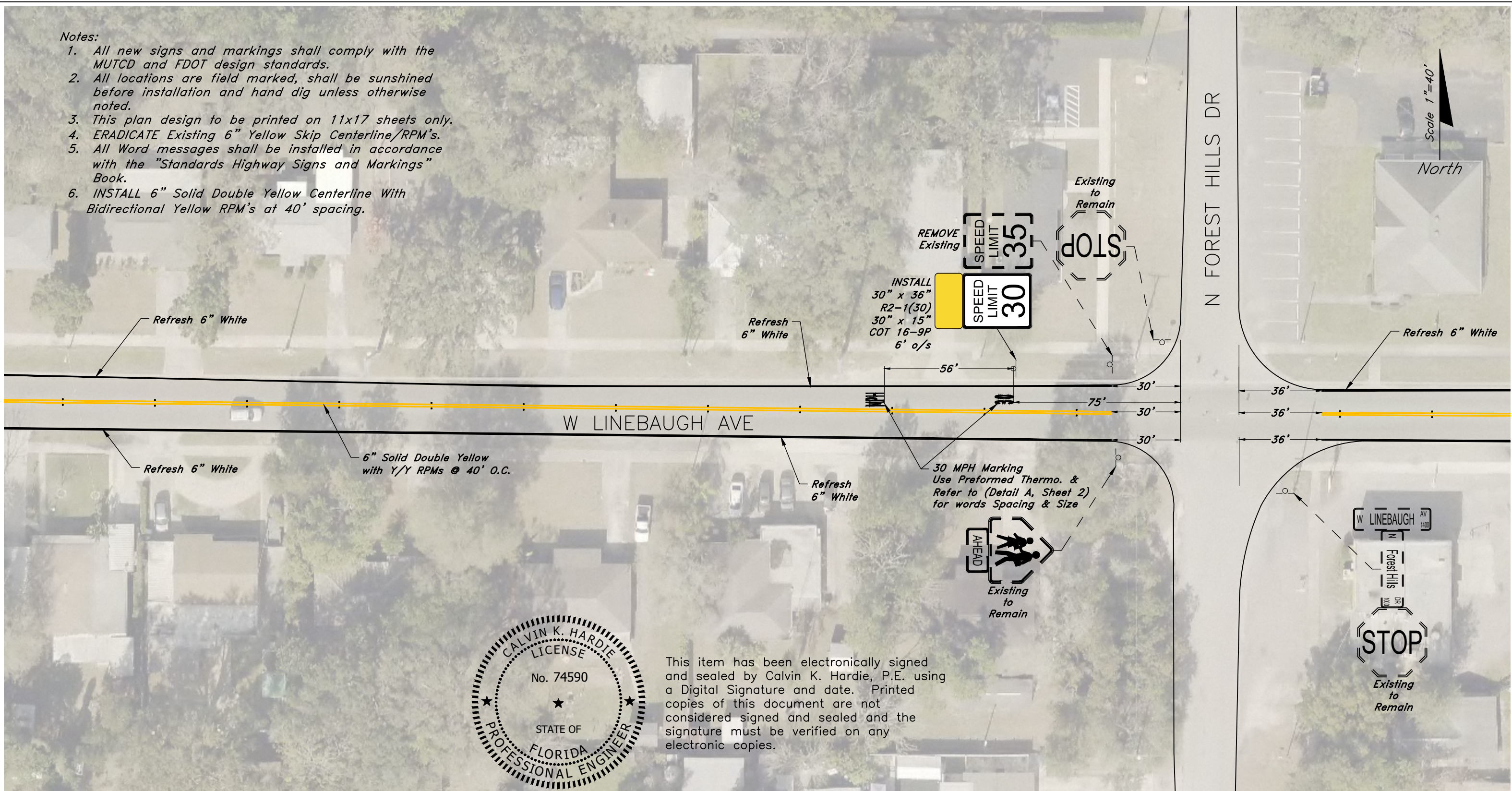

This item has been electronically signed and sealed by Calvin K. Hardie, P.E. using a Digital Signature and date. Printed copies of this document are not considered signed and sealed and the signature must be verified on any electronic copies.

WORK REQUEST NO. N0313	REQUESTED BY:	CALVIN HARDIE, P.E. P.E. LICENSE NUMBER 75490 CITY OF TAMPA CHIEF TRANSPORTATION ENGINEER 306 E JACKSON STREET TAMPA, FLORIDA 33602	CITY OF TAMPA TRANSPORTATION AND STORMWATER SERVICES DEPARTMENT			SHEET NO. 4 of 11
	PRIORITY: <input type="radio"/> AVG <input checked="" type="radio"/> HIGH <input type="radio"/> SPECIAL CASE		DESIGNED BY H. Nasralla	CHECKED BY B. Corey	DATE 11/18/2019	
		W LINEBAUGH AVE From N Armenia Ave To N Florida Ave Signing & Pavement Markings Upgrades				

Notes:

1. All new signs and markings shall comply with the MUTCD and FDOT design standards.
2. All locations are field marked, shall be sunshined before installation and hand dig unless otherwise noted.
3. This plan design to be printed on 11x17 sheets only.
4. ERADICATE Existing 6" Yellow Skip Centerline/RPM's.
5. All Word messages shall be installed in accordance with the "Standards Highway Signs and Markings" Book.
6. INSTALL 6" Solid Double Yellow Centerline With Bidirectional Yellow RPM's at 40' spacing.

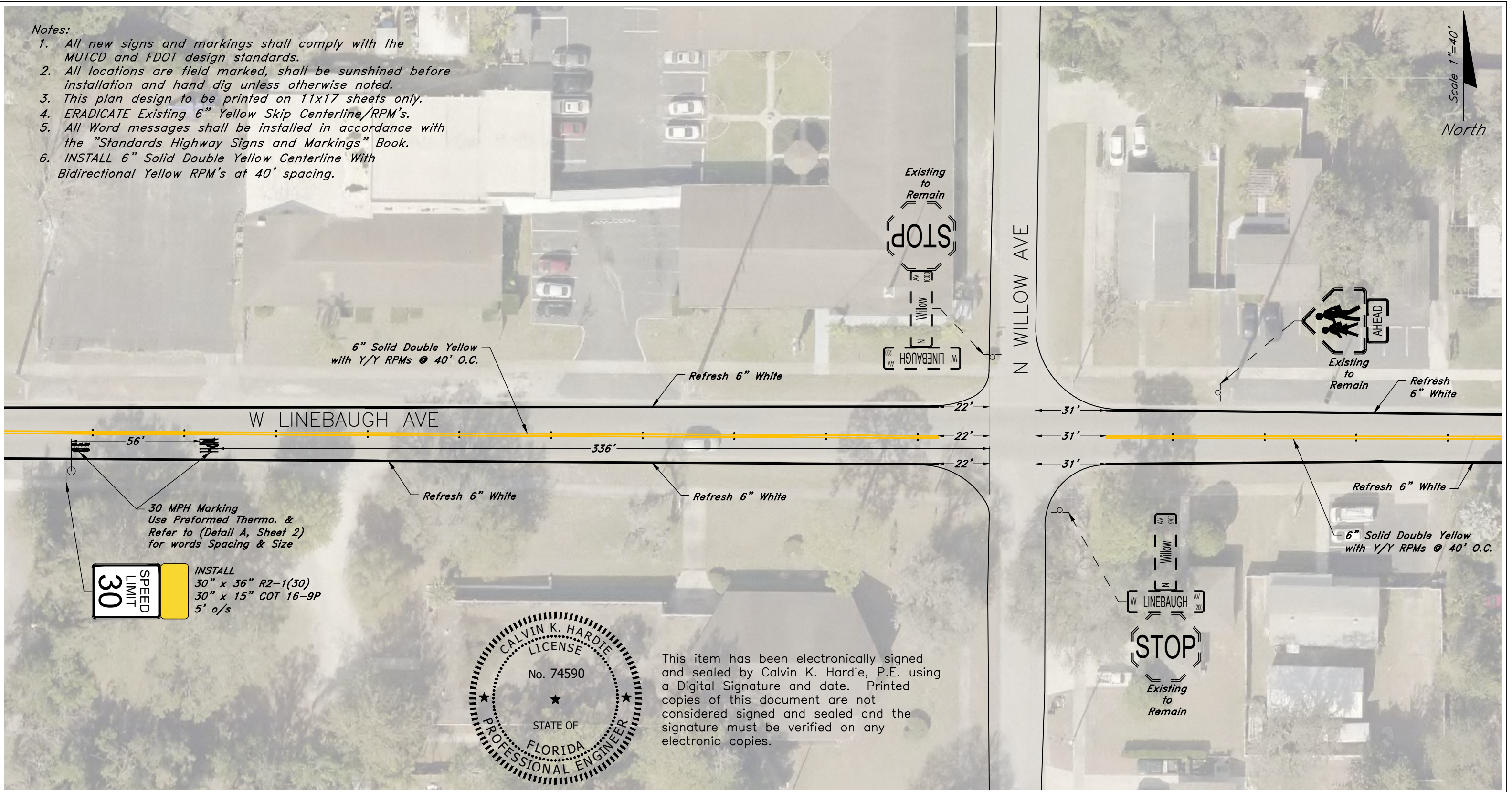
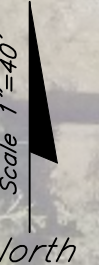

30 MPH Marking
Use Prefomed Thermo. &
Refer to (Detail A, Sheet 2)
for words Spacing & Size

INSTALL
30" x 36" R2-1(30)
30" x 15" COT 16-9P
5' o/s

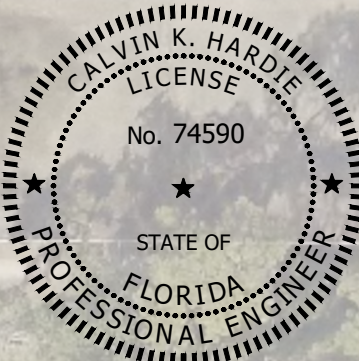

This item has been electronically signed and sealed by Calvin K. Hardie, P.E. using a Digital Signature and date. Printed copies of this document are not considered signed and sealed and the signature must be verified on any electronic copies.

WORK REQUEST NO. N0313	REQUESTED BY:	CALVIN HARDIE, P.E. P.E. LICENSE NUMBER 75490 CITY OF TAMPA CHIEF TRANSPORTATION ENGINEER 306 E JACKSON STREET TAMPA, FLORIDA 33602	CITY OF TAMPA TRANSPORTATION AND STORMWATER SERVICES DEPARTMENT			W LINEBAUGH AVE From N Armenia Ave To N Florida Ave	SHEET NO. 5 of 11
	PRIORITY: <input type="radio"/> AVG <input checked="" type="radio"/> HIGH <input type="radio"/> SPECIAL CASE		DESIGNED BY H. Nasralla	CHECKED BY B. Corey	DATE 11/18/2019		

Notes:

1. All new signs and markings shall comply with the MUTCD and FDOT design standards.
2. All locations are field marked, shall be sunshined before installation and hand dig unless otherwise noted.
3. This plan design to be printed on 11x17 sheets only.
4. ERADICATE Existing 6" Yellow Skip Centerline/RPM's.
5. All Word messages shall be installed in accordance with the "Standards Highway Signs and Markings" Book.
6. INSTALL 6" Solid Double Yellow Centerline With Bidirectional Yellow RPM's at 40' spacing.

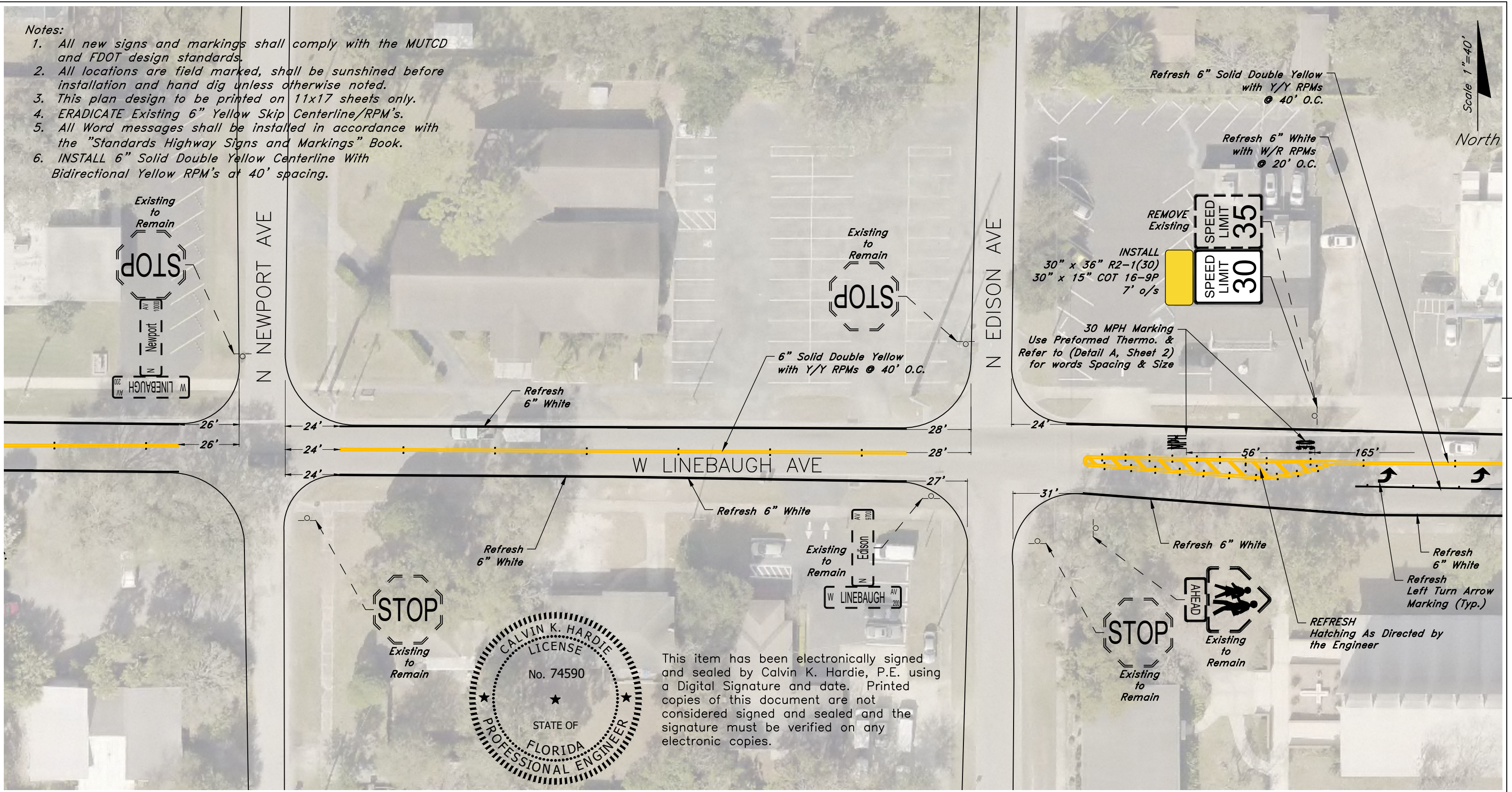

This item has been electronically signed and sealed by Calvin K. Hardie, P.E. using a Digital Signature and date. Printed copies of this document are not considered signed and sealed and the signature must be verified on any electronic copies.

WORK REQUEST NO. NO313	REQUESTED BY:	CALVIN HARDIE, P.E. P.E. LICENSE NUMBER 75490 CITY OF TAMPA CHIEF TRANSPORTATION ENGINEER 306 E JACKSON STREET TAMPA, FLORIDA 33602	CITY OF TAMPA TRANSPORTATION AND STORMWATER SERVICES DEPARTMENT			W LINEBAUGH AVE From N Armenia Ave To N Florida Ave	SHEET NO.
	PRIORITY: <input type="radio"/> AVG <input checked="" type="radio"/> HIGH <input type="radio"/> SPECIAL CASE		DESIGNED BY H. Nasralla	CHECKED BY B. Corey	DATE 11/18/2019		Signing & Pavement Markings Upgrades

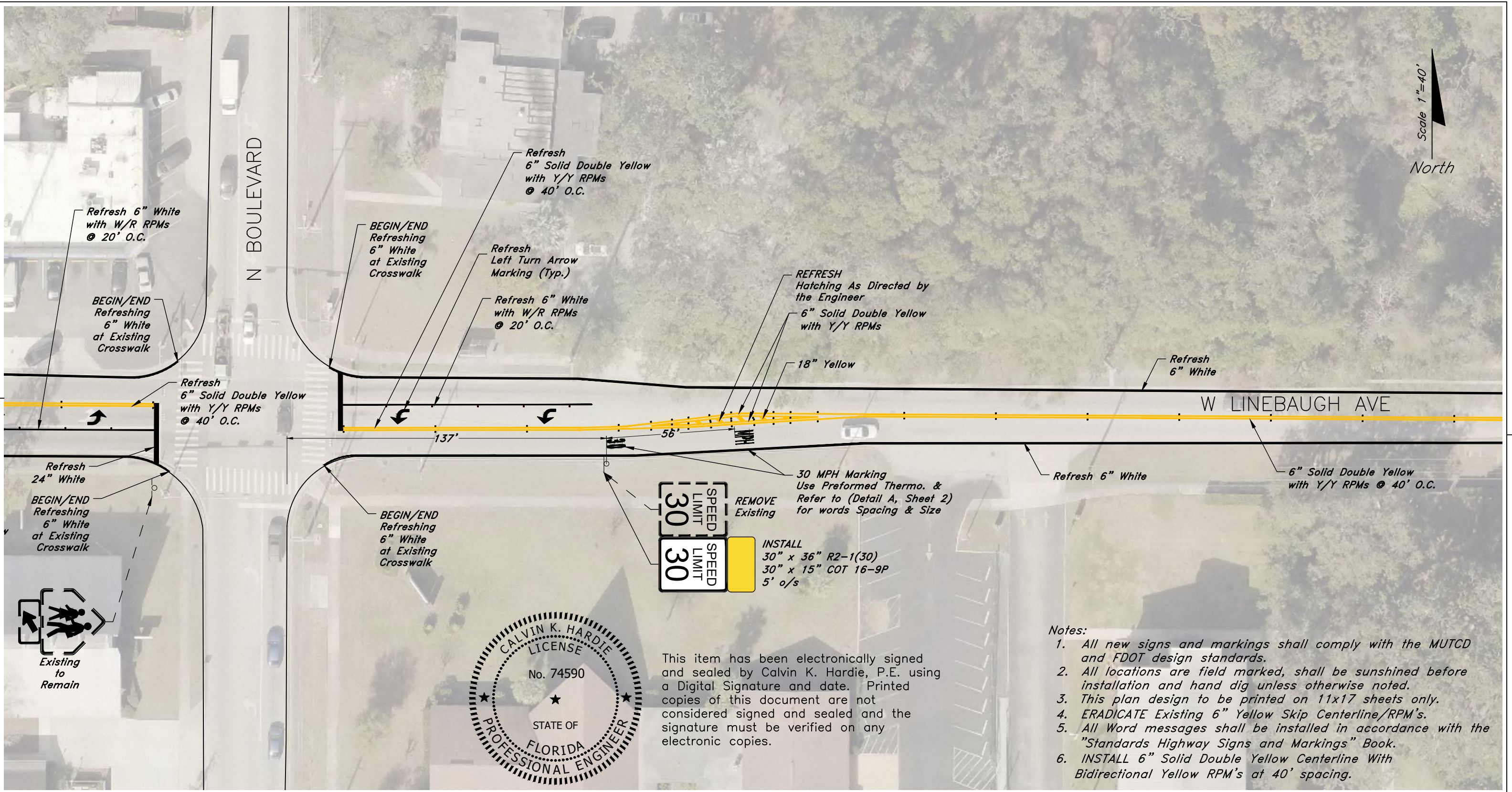

Scale 1"=40'
North

Refresh 6" White with W/R RPMs @ 20' O.C.

BEGIN/END Refreshing 6" White at Existing Crosswalk

Refresh 6" Solid Double Yellow with Y/Y RPMs @ 40' O.C.

Refresh 24" White
BEGIN/END Refreshing 6" White at Existing Crosswalk



BEGIN/END Refreshing 6" White at Existing Crosswalk

Refresh Left Turn Arrow Marking (Typ.)

Refresh 6" White with W/R RPMs @ 20' O.C.

BEGIN/END Refreshing 6" White at Existing Crosswalk

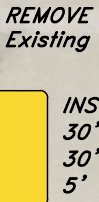
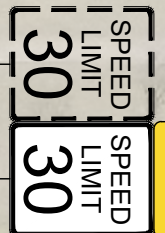
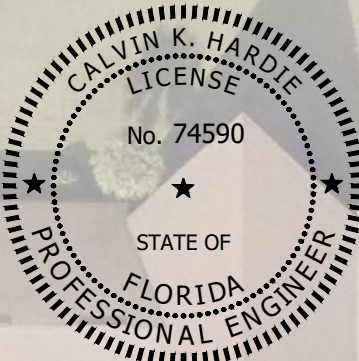

REMOVE Existing
INSTALL 30" x 36" R2-1(30)
30" x 15" COT 16-9P
5' o/s

30 MPH Marking Use Preformed Thermo. & Refer to (Detail A, Sheet 2) for words Spacing & Size

This item has been electronically signed and sealed by Calvin K. Hardie, P.E. using a Digital Signature and date. Printed copies of this document are not considered signed and sealed and the signature must be verified on any electronic copies.

REFRESH Hatching As Directed by the Engineer
6" Solid Double Yellow with Y/Y RPMs
18" Yellow

Refresh 6" White

W LINEBAUGH AVE

Refresh 6" White

6" Solid Double Yellow with Y/Y RPMs @ 40' O.C.

Notes:

1. All new signs and markings shall comply with the MUTCD and FDOT design standards.
2. All locations are field marked, shall be sunshined before installation and hand dig unless otherwise noted.
3. This plan design to be printed on 11x17 sheets only.
4. ERADICATE Existing 6" Yellow Skip Centerline/RPM's.
5. All Word messages shall be installed in accordance with the "Standards Highway Signs and Markings" Book.
6. INSTALL 6" Solid Double Yellow Centerline With Bidirectional Yellow RPM's at 40' spacing.

WORK REQUEST NO. N0313	REQUESTED BY:	CALVIN HARDIE, P.E. P.E. LICENSE NUMBER 75490 CITY OF TAMPA CHIEF TRANSPORTATION ENGINEER 306 E JACKSON STREET TAMPA, FLORIDA 33602	CITY OF TAMPA TRANSPORTATION AND STORMWATER SERVICES DEPARTMENT			SHEET NO. 7 of 11
	PRIORITY: <input type="radio"/> AVG <input checked="" type="radio"/> HIGH <input type="radio"/> SPECIAL CASE		DESIGNED BY H. Nasralla	CHECKED BY B. Corey	DATE 11/18/2019	

Notes:

1. All new signs and markings shall comply with the MUTCD and FDOT design standards.
2. All locations are field marked, shall be sunshined before installation and hand dig unless otherwise noted.
3. This plan design to be printed on 11x17 sheets only.
4. ERADICATE Existing 6" Yellow Skip Centerline/RPM's.
5. All Word messages shall be installed in accordance with the "Standards Highway Signs and Markings" Book.
6. INSTALL 6" Solid Double Yellow Centerline With Bidirectional Yellow RPM's at 40' spacing.

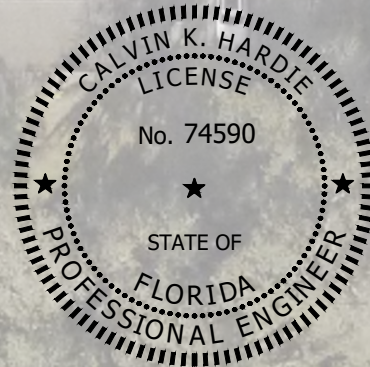
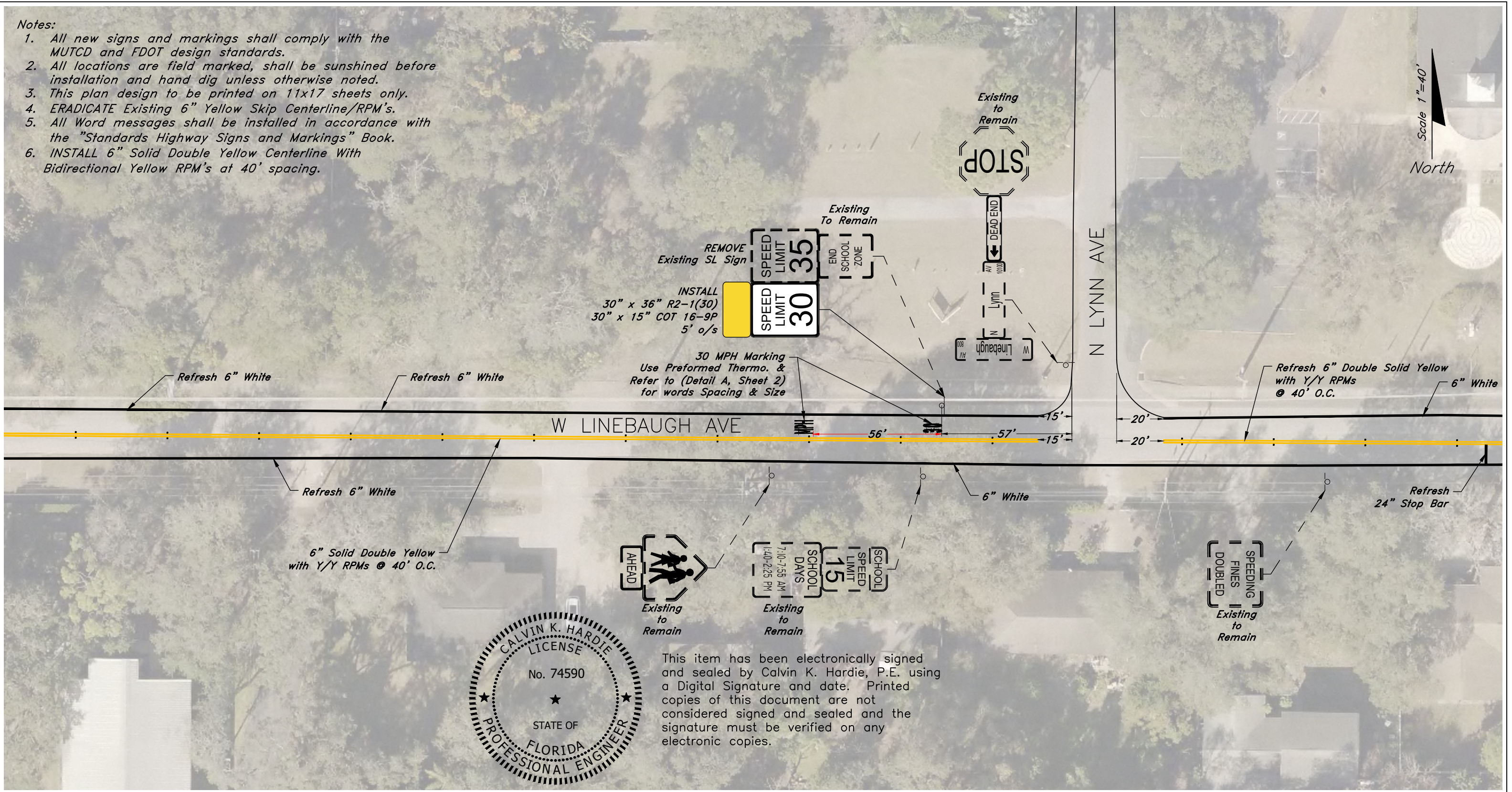

This item has been electronically signed and sealed by Calvin K. Hardie, P.E. using a Digital Signature and date. Printed copies of this document are not considered signed and sealed and the signature must be verified on any electronic copies.

WORK REQUEST NO. N0313	REQUESTED BY:	CALVIN HARDIE, P.E. P.E. LICENSE NUMBER 75490 CITY OF TAMPA CHIEF TRANSPORTATION ENGINEER 306 E JACKSON STREET TAMPA, FLORIDA 33602	CITY OF TAMPA TRANSPORTATION AND STORMWATER SERVICES DEPARTMENT			W LINEBAUGH AVE From N Armenia Ave To N Florida Ave	SHEET NO.
	PRIORITY: <input type="radio"/> AVG <input checked="" type="radio"/> HIGH <input type="radio"/> SPECIAL CASE		DESIGNED BY H. Nasralla	CHECKED BY B. Corey	DATE 11/18/2019		Signing & Pavement Markings Upgrades

Notes:

1. All new signs and markings shall comply with the MUTCD and FDOT design standards.
2. All locations are field marked, shall be sunshined before installation and hand dig unless otherwise noted.
3. This plan design to be printed on 11x17 sheets only.
4. ERADICATE Existing 6" Yellow Skip Centerline/RPM's.
5. All Word messages shall be installed in accordance with the "Standards Highway Signs and Markings" Book.
6. INSTALL 6" Solid Double Yellow Centerline With Bidirectional Yellow RPM's at 40' spacing.

Scale 1"=40'
North

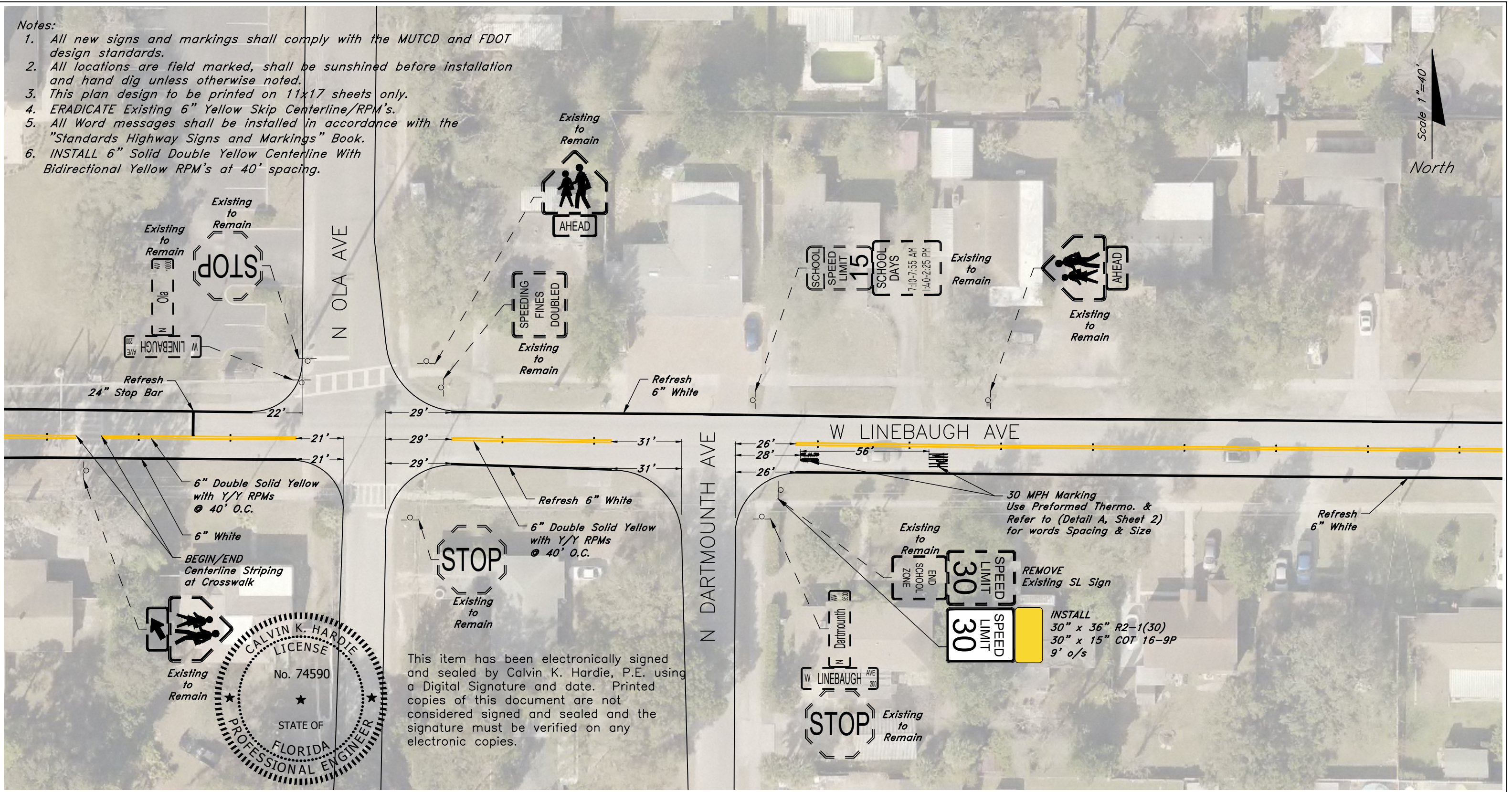

This item has been electronically signed and sealed by Calvin K. Hardie, P.E. using a Digital Signature and date. Printed copies of this document are not considered signed and sealed and the signature must be verified on any electronic copies.

WORK REQUEST NO. NO313	REQUESTED BY:	CALVIN HARDIE, P.E. P.E. LICENSE NUMBER 75490 CITY OF TAMPA CHIEF TRANSPORTATION ENGINEER 306 E JACKSON STREET TAMPA, FLORIDA 33602	CITY OF TAMPA TRANSPORTATION AND STORMWATER SERVICES DEPARTMENT			W LINEBAUGH AVE From N Armenia Ave To N Florida Ave	SHEET NO.
	PRIORITY: <input type="radio"/> AVG <input checked="" type="radio"/> HIGH <input type="radio"/> SPECIAL CASE		DESIGNED BY H. Nasralla	CHECKED BY B. Corey	DATE 11/18/2019		Signing & Pavement Markings Upgrades

Notes:

1. All new signs and markings shall comply with the MUTCD and FDOT design standards.
2. All locations are field marked, shall be sunshined before installation and hand dig unless otherwise noted.
3. This plan design to be printed on 11x17 sheets only.
4. ERADICATE Existing 6" Yellow Skip Centerline/RPM's.
5. All Word messages shall be installed in accordance with the "Standards Highway Signs and Markings" Book.
6. INSTALL 6" Solid Double Yellow Centerline With Bidirectional Yellow RPM's at 40' spacing.

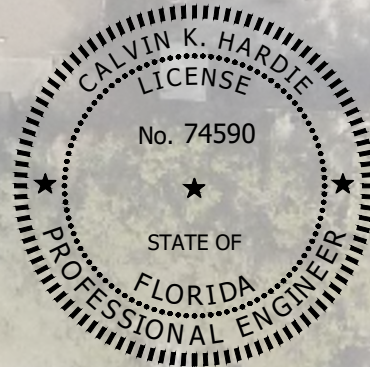
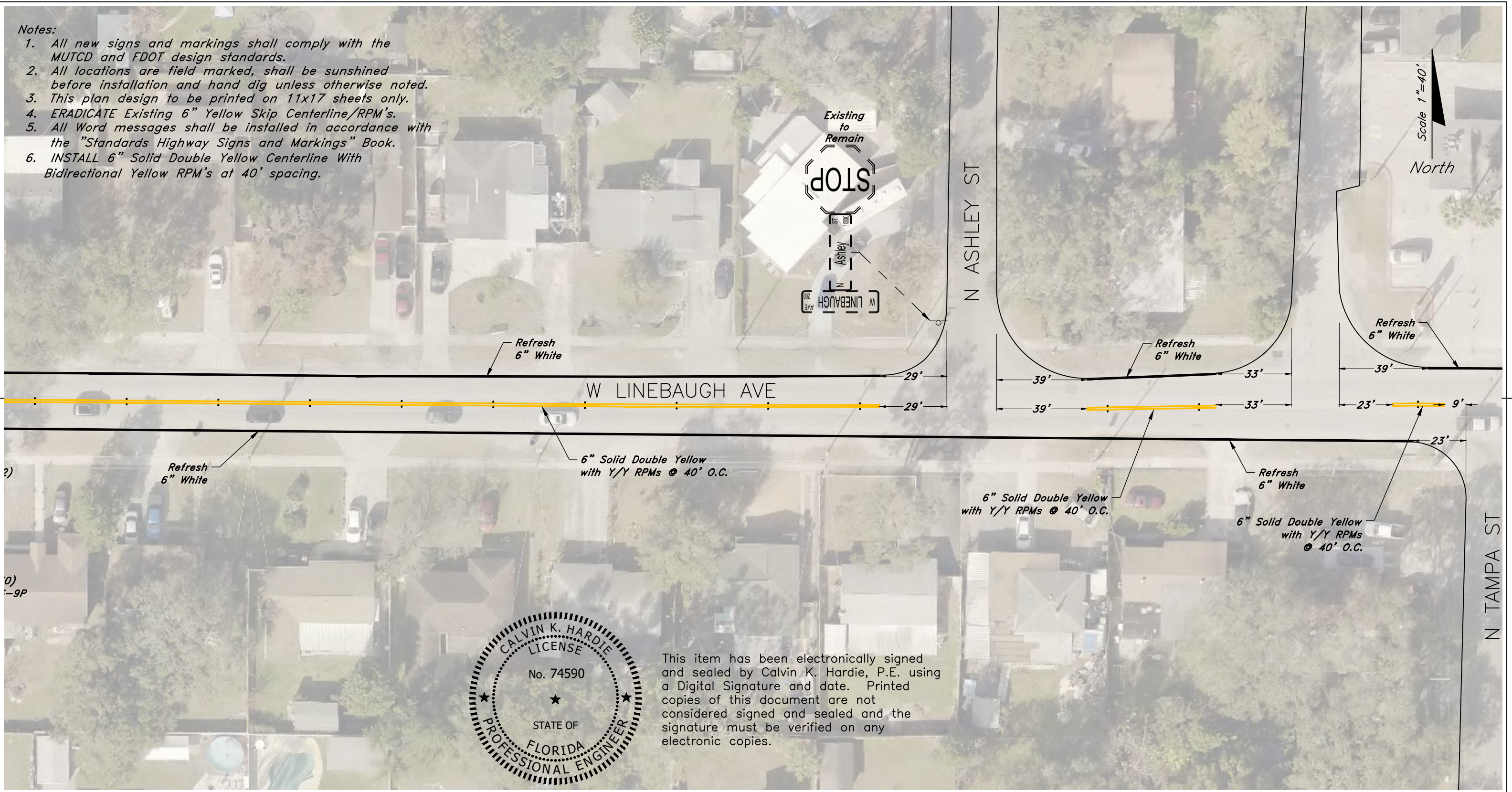

This item has been electronically signed and sealed by Calvin K. Hardie, P.E. using a Digital Signature and date. Printed copies of this document are not considered signed and sealed and the signature must be verified on any electronic copies.

WORK REQUEST NO. NO313	REQUESTED BY:	CALVIN HARDIE, P.E. P.E. LICENSE NUMBER 75490 CITY OF TAMPA CHIEF TRANSPORTATION ENGINEER 306 E JACKSON STREET TAMPA, FLORIDA 33602	CITY OF TAMPA TRANSPORTATION AND STORMWATER SERVICES DEPARTMENT			W LINEBAUGH AVE From N Armenia Ave To N Florida Ave	SHEET NO.
	PRIORITY: <input type="radio"/> AVG <input checked="" type="radio"/> HIGH <input type="radio"/> SPECIAL CASE		DESIGNED BY H. Nasralla	CHECKED BY B. Corey	DATE 11/18/2019		Signing & Pavement Markings Upgrades

Notes:

1. All new signs and markings shall comply with the MUTCD and FDOT design standards.
2. All locations are field marked, shall be sunshined before installation and hand dig unless otherwise noted.
3. This plan design to be printed on 11x17 sheets only.
4. ERADICATE Existing 6" Yellow Skip Centerline/RPM's.
5. All Word messages shall be installed in accordance with the "Standards Highway Signs and Markings" Book.
6. INSTALL 6" Solid Double Yellow Centerline With Bidirectional Yellow RPM's at 40' spacing.

Scale 1"=40'
North

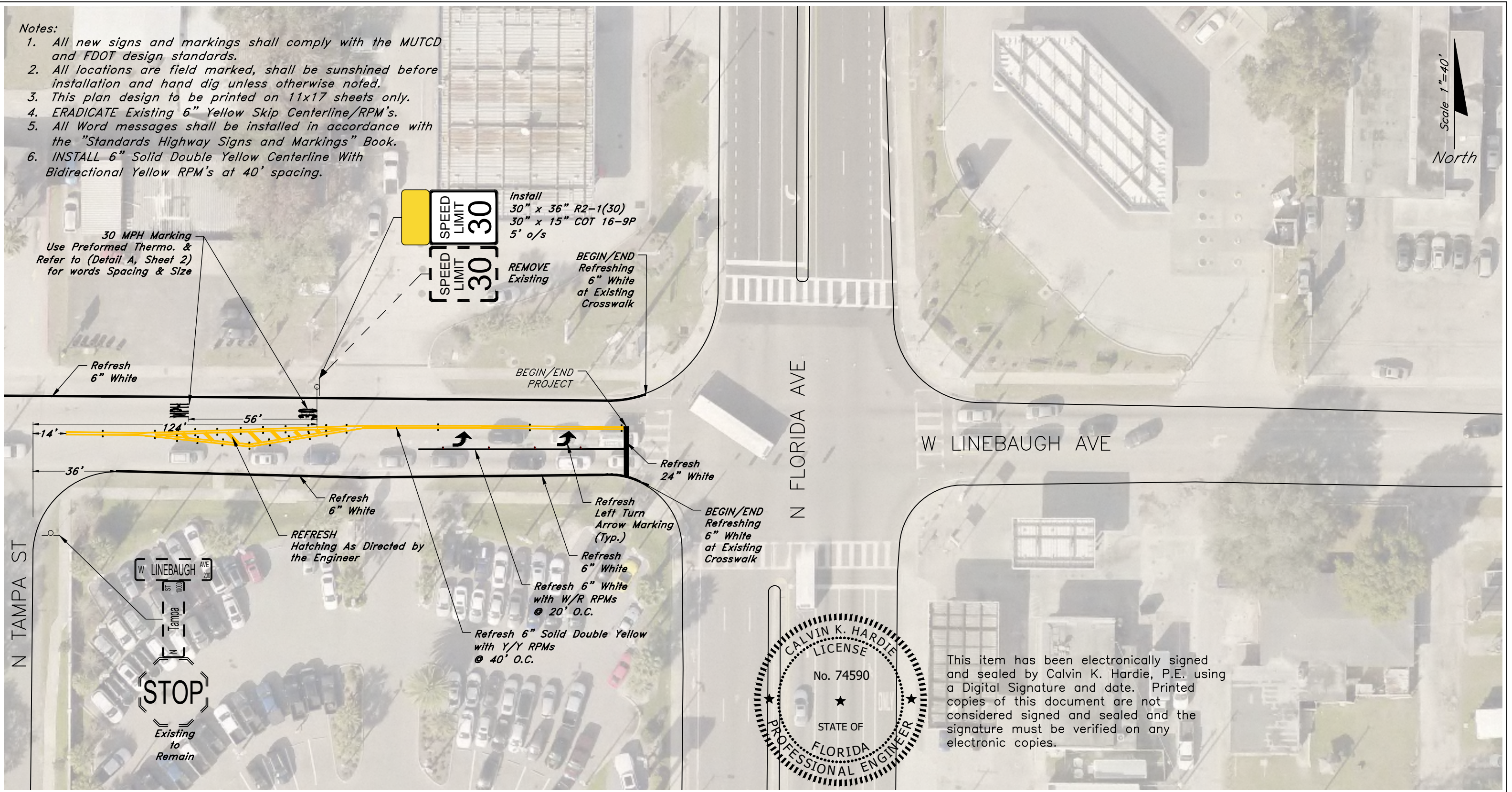

Install
30" x 36" R2-1(30)
30" x 15" COT 16-9P
5' o/s

REMOVE Existing

BEGIN/END Refreshing 6" White at Existing Crosswalk

30 MPH Marking
Use Preformed Thermo. & Refer to (Detail A, Sheet 2) for words Spacing & Size

Refresh 6" White

BEGIN/END PROJECT

Refresh 24" White

Refresh 6" White

REFRESH Hatching As Directed by the Engineer

Refresh Left Turn Arrow Marking (Typ.)

Refresh 6" White

Refresh 6" White with W/R RPMs @ 20' O.C.

Refresh 6" Solid Double Yellow with Y/Y RPMs @ 40' O.C.

BEGIN/END Refreshing 6" White at Existing Crosswalk

STOP
Existing to Remain

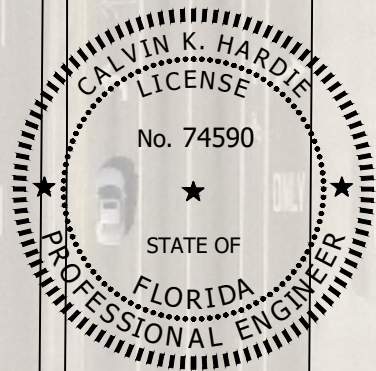

This item has been electronically signed and sealed by Calvin K. Hardie, P.E. using a Digital Signature and date. Printed copies of this document are not considered signed and sealed and the signature must be verified on any electronic copies.

WORK REQUEST NO. N0313	REQUESTED BY:	CALVIN HARDIE, P.E. P.E. LICENSE NUMBER 75490 CITY OF TAMPA CHIEF TRANSPORTATION ENGINEER 306 E JACKSON STREET TAMPA, FLORIDA 33602	CITY OF TAMPA TRANSPORTATION AND STORMWATER SERVICES DEPARTMENT			W LINEBAUGH AVE From N Armenia Ave To N Florida Ave	SHEET NO.
	PRIORITY: <input type="radio"/> AVG <input checked="" type="radio"/> HIGH <input type="radio"/> SPECIAL CASE		DESIGNED BY H. Nasralla	CHECKED BY B. Corey	DATE 11/18/2019		Signing & Pavement Markings Upgrades